

# Safety Operator's Manual

3250200051

## LG Rotary Hoe



**MODEL:**

**LG-90**

**LG-100**

**LG-105**

**LG-125**

**LG-135**

**LG-150**

**LG-180**

Read these instructions before installing and using this implement

# CONTENTS

<b>Safety operation warning</b> .....	<b>1</b>
<b>Precautions for safe operation</b>	
Preparations before homework .....	4
In operation .....	6
After homework.....	7
<b>1.Connection with tractor</b>	
Part names and functions .....	8
Parts assembly .....	10
Connection with tractor .....	11
<b>2. Pre-work inspection</b>	
Inspection before operation .....	15
Check at engine start.....	16
<b>3. gas station summary</b>	
Gearbox .....	17
<b>4.Operation essentials</b>	
Precautions when using .....	18
Rotary tiller adjustment .....	19
<b>5.Homework end</b>	
Finishing and inspection after the work.....	20
Separation from tractor .....	20
save .....	20
<b>6.Check parts and adjustments</b>	
Checklist .....	20
Blade replacement .....	20
<b>7.Eception handling</b>	
<b>8.Product Parts Atlas</b>	
Rotary tiller machine .....	22
Knife shaft.....	28
<b>9. Main technical parameters of flail mower</b>	
<b>10. Consumable parts list</b>	



## Safety instructions

## Warning label meaning



note! Before using the machine, carefully read the instruction manual. Failure to observe this warning may



caveat! Keep away from the cutting area of the running machine. If this warning is not observed, personal injury



Danger! Keep away from moving parts of the machine during driving or operation. Failure to comply with this warning will



caveat! Keep a safe distance while driving the tractor. If this warning is not observed, personal injury may occur

Precautions for safe



If the following precautions are not followed, death or injury may occur!



Please read the instruction manual of the machine and tractor carefully before use, and start to use it after fully understanding.



Danger! Failure to observe this warning may cause serious accidents such as death or serious injury.



caveat! If this warning is not observed, personal injury may occur.



note! Failure to observe this warning may result in injury.

### Preparations before homework

Read the instructions carefully before starting work



note !

- ★ If you do not fully understand the safety precautions and use methods described in the instruction manual, you will cause unexpected accidents. Before the operation, please put the warning sign on the product, and the safety precautions and usage instructions in the instruction manual before you fully understand it.

Place the instruction manual around the product



note !

- ★ If you do not know how to operate the machine, if the instruction manual is not placed around the product, if you only use your own judgment to deal with it, unexpected accidents may occur and cause injury. Make sure that the instruction manual is kept around the product, and you can read it at any time when you do n't know how to use it.

Do not operate in the following situations



caveat !

- ★ Unexpected accidents may occur when operating in an uncomfortable body or unfamiliar with machine operation.
- Do not operate under the following conditions:
- When you are too tired, sick, under the influence of drugs, and other reasons that make your work unable to concentrate.
  - After drinking.
  - People who are not skilled in mechanical operation.
  - Pregnant women and minors.

Clothing selection during operation



caveat !

- ★ If the machine is operated with unsuitable clothing, a part of the clothes will be caught by the machine and be injured. In serious cases, a fatal accident may occur.
- Please follow the clothing tips below:
- Don't wear oversized jackets and pants.
  - The sleeves and placket should not be too large.
  - Wear a hard hat. Do not tie headbands, waistbands, and other ribbon-shaped or flocculent items on the head and waist.
  - Do not tie headbands, waistbands, and other ribbon-shaped or flocculent items on the head and waist.

### When the machine is loaned



c

- ★ The machine is loaned to others, and the safety warning and detailed operation instructions described in the instruction manual must be clearly informed. The instruction manual should be delivered and instructed to read it carefully when using it

### Prohibition of machine modification



note!

- ★ If you modify the machine yourself or install devices and components other than those specified by the company for operation, it will cause damage to the machine and an accident of injury. Please use the configuration parts specified by our company. When replacing parts, you can choose according to the catalog.

### Machine startup and departure



caveat!

- ★ Ensure that the machine is accurately connected and mounted on the tractor three-point suspension.
- ★ When starting the tractor engine, make sure that the tractor is in neutral, if it is in gear, it may cause the tractor to lose control and cause unexpected accidents.
- ★ Be sure to cut off the PTO and start the engine. If you do not cut off the PTO to start the engine, the machine is suddenly driven, which may cause injuries to people around you.
- ★ If the tractor starts to move forward at a high speed, it may cause the front wheel of the tractor to tilt, and the operator may be thrown down, and people around may also be involved, and unexpected accidents may occur. After confirming that the surrounding conditions are safe, start the low gear forward.
- ★ When starting indoors, the exhausted gas may cause poisoning accidents, please be sure to open the doors and windows to fully ventilate.

### Loading operation machine



caveat!

- ★ When moving the tractor, if there is someone between the work machine and the tractor, an accident of being pinched may occur. Do not approach between tractor and work machine.
- ★ When the tractor is loaded with a working machine, such as on a slope, uneven ground or soft ground, the tractor suddenly moves, which may cause unexpected accidents. Please carry out stowage work on a flat, hard ground.
- ★ Due to the different tractor models, if the front wheel load is too light, it will cause unstable tractor operation and cause accidents. Please install a suitable weight before loading the working machine to keep the overall center of gravity of the tractor and the working machine balanced.

### Use of universal coupling



caveat!

- ★ Please do not use a universal coupling without a plastic cover, otherwise you may get injured due to being caught in.
- ★ Always cut off the engine when removing the coupling.
- ★ Be sure to fix the chain of the plastic cover, otherwise there will be injuries caused by being caught. See page 13 for specific application requirements of the coupling.

## When walking



### Danger!

- ★ When the loading machine moves and walks, make sure to connect the left and right brake pedals before use.
- ★ If a person other than the driver rides on the tractor, falls from the tractor, hindering the driving operation, and cannot respond to emergency situations, not only the passengers, but also the surrounding people and the driver themselves will cause injuries.
- ★ If you make an emergency braking or a sharp turn, the driver may be thrown off, which may involve people around you and cause unexpected accidents. Please do not perform a sudden braking or a sharp turn.
- ★ When turning, due to the increased turning radius of the loading machine, it will contact people or objects around. Please keep a relatively safe distance from people, objects, and obstacles before turning.
- ★ In the case of ramps, uneven ground, and excessive turning speed, it may cause rollover or collision accidents. Please walk at low speed in the above light type.
- ★ When walking on a terrain with a large drop, it may cause rollover, rollover, or damage to the working machine. Please use suitable pads.
- ★ If people or objects are loaded on the working machine, it may cause injury after falling. Do not

## In operation

### During the operation



### Danger!

- ★ If the rotary cutter is touched during the operation or rotation of the machine, an injury accident may occur. If it is close to the machine, the high-speed rotating cutter head may scatter the stones and cause injury. When working, please keep people around you away.
- ★ If the operation exceeds the PTO speed set by the machine, it will cause damage to the machine, and injury will occur due to the damage. Please follow the specified speed to work.
- ★ If people or objects are loaded on the working machine, it may cause injury after falling. Do not carry people or objects on the working machine.
- ★ When walking on a ramp at high speed, it may cause sideslip or rollover. Please downshift and slow down before entering the ramp to smoothly cross the slope.
- ★ Be sure to concentrate and drive carefully when working.
- ★ If someone approaches when lifting the header, there may be an injury accident. Please stay away.
- ★ Inclined surface operation may cause the tractor to slip or roll over. Please do not get too close to the inclined surface to reduce walking and operating speed.
- ★ When adjusting the machine and removing debris, be sure to cut off the PTO engine and stop the tractor. Otherwise, due to the inattention of the third party, the work machine suddenly starts, which may cause unexpected things to happen.
- ★ When leaving the tractor, please stop on a flat ground, cut off the engine after landing the work machine, and apply the brake to prevent the machine from losing control.

## After homework

### Body cleaning



note!

- ★ When performing collective cleaning, be sure to cut off the PTO engine, stop the tractor engine, and make sure that the rotating parts stop before cleaning.

### Body inspection



note!

- ★ If the inspection work after the operation is neglected, the poor adjustment and damage of the machine are not found in time, and a failure or injury accident will occur during the next operation. After the operation, please follow the instructions strictly after the operation.
- ★ When using the 3-point suspension to lift the working machine for inspection and adjustment, due to the inattention of the third party, an accident may occur due to a sudden drop. Please lock the oil circuit of the tractor three-point suspension before proceeding.

### Machine storage



note!

- ★ If the rotary tiller is stored upright, an accident may occur after turning over. To prevent overturning, store the header flat and store it

### Bad handling, inspection, maintenance attention



note!

- ★ If the machine is abnormal, ignoring it will cause damage or injury. Please follow the instruction manual for maintenance.
- ★ When the tractor is loading a working machine, such as on a slope, uneven ground, or soft ground, the sudden action of the garbage will cause unexpected accidents. Please carry out stowage work on a flat, hard ground.
- ★ When adjusting the machine and removing debris, be sure to cut off the PTO engine and stop the tractor. Otherwise, due to the inattention of the third party, the work machine suddenly starts, which may cause unexpected things to happen.
- ★ When lifting the working machine and drilling into the lower part or entering with the feet, the machine may suddenly fall and cause injury. Before drilling, be sure to make a platform and auxiliary support before proceeding.
- ★ If the hydraulic joints and hoses are loose or damaged, the high-pressure oil sprayed or the rapid drop of the working machine will cause injury. Please repair or replace parts in time. When replacing the joint or tubing, it must be carried out under pressureless conditions in the crude oil tubing.
- ★ The protective parts of the shell are removed for bad handling, inspection and maintenance, and they must be installed back to the original place after completion. Otherwise, you will be involved in the operation and cause injury.

# 1. Connection with tractor

## 1. Name and function of each part

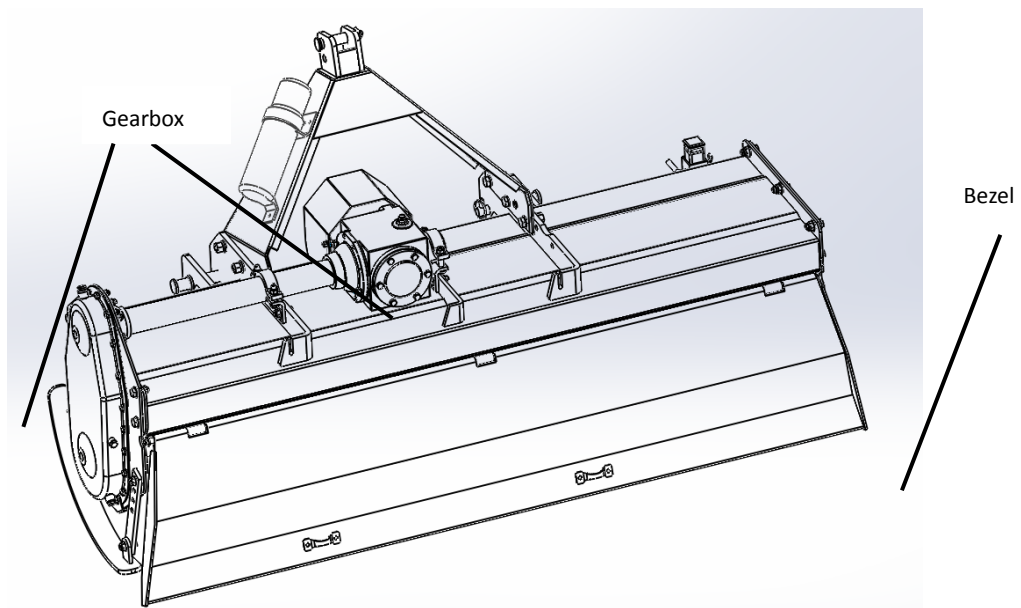
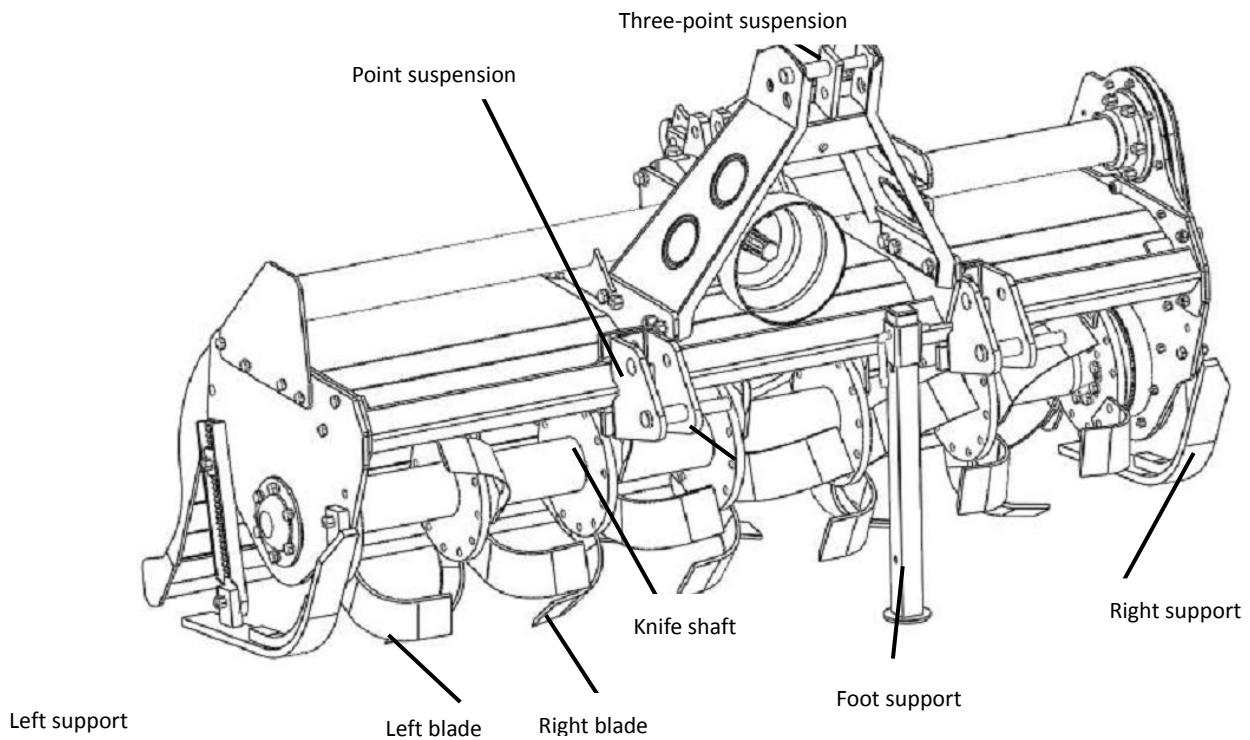

- (1) Three-point suspension  
Connect the tractor to the rotary tiller body.
- (2) Left and right support frame



Adjustable tillage depth, which plays a role in guiding the rotation till the machine works.

After the rotary tiller stops working, avoid directly grounding the blade and place the machine steadily.

**(3) Left and right blades**

For cutting soil.

**(4) Cutter shaft**

Drive the blade to rotate.

**(5) foot support**

After the rotary tiller stops working, avoid directly grounding the blade and place the machine steadily.

**(6) Adjust the pull plate**

Connect the three-point suspension to the gear box to reduce the vibration of the gear box and the whole machine.

**(7) Gear box**

Change the output speed of the tractor and transmit power to the cutter shaft.

**(8) Baffle**

## 1. Assembly of parts

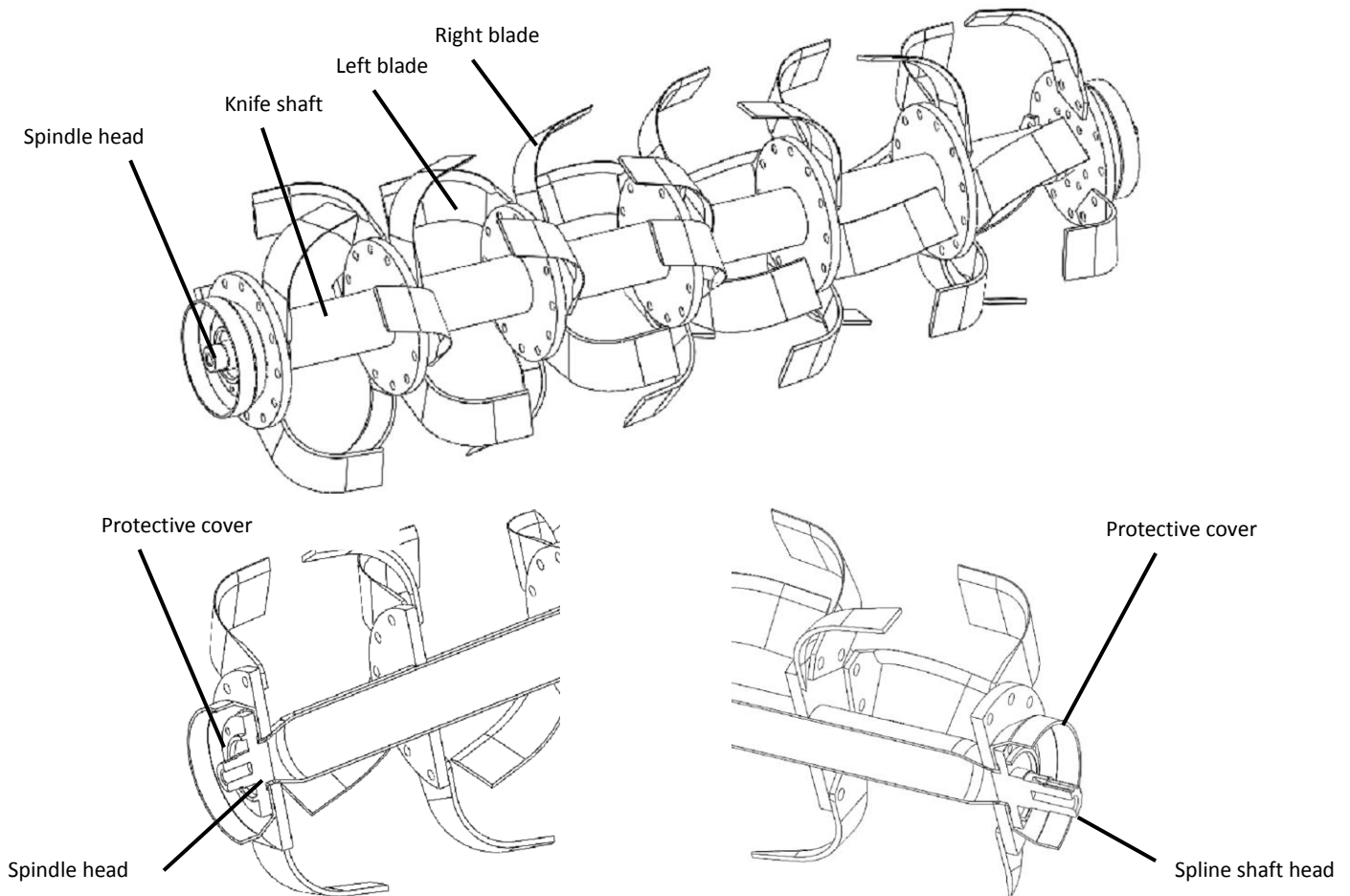

(1) Check whether the appearance of the parts is damaged, and whether the blades have curling problems. Replace the parts in time when there is a problem.

(2) Assembly parts details

According to the details provided by the explosion diagram, confirm whether the necessary parts are complete.

(3) Assemble shaft head, spline shaft head, protective cover, blade

When installing, follow the order from left to right or from right to left. The bolts and nuts are tightened to prevent the machine from working. After shaking, the shaft heads on both sides are preferentially installed, and finally the blade is installed;

1. When installing the shaft head and spline shaft head, make sure it is concentric with the cutter shaft;

2. When installing the left and right blades, install one row in the radial direction with the blade shaft, and rotate the  $15^\circ$  to install the second row.

The spring washer and the lock nut are combined and tightened; the blades on both ends of the knife shaft are 3 pieces, and the left and right are opposite.

(4) Check after installation

After installation, check whether the blade direction is consistent with the actual working direction and whether the blade is loose;  
 Rotate the knife shaft by hand to see if the knife shaft has runout problems during rotation, and whether the rotation is flexible and reliable;

## Connection with tractor

### (1) Three-point suspension connection



#### caveat!

- ★ In the process of connecting the working machine, when the tractor is moving, if there is someone between the tractor and the working machine, it may cause an accident. It must be ensured that no one is between the tractor and the working machine



#### note!

- ★ When the tractor is loading a working machine, such as on a slope, uneven ground, or soft ground, the sudden action of the garbage will cause unexpected accidents. Please carry out stowage work on a flat, hard ground.
- ★ Due to the different tractor models, if the front wheel load is too light, it will cause unstable tractor operation and cause accidents. Please install a suitable weight before loading the working machine to keep the overall center of gravity of the tractor and the working machine balanced.

Type of lower suspension pin	
CTL150	I 、 II
CTL160	I 、 II
CTL185	I 、 II
CTL210	I 、 II

### (2) Connection and adjustment



**note! Make sure the tractor is fixed when mounting the connection.**

- a. Start the tractor engine, the position of the lower connecting rod head of the tractor corresponds to the position of the lower suspension pin of the machine, backward, stop, stop the engine, and engage the parking gear.
- b. For the connection of the left traction arm, insert the left traction arm on the tractor into the left suspension pin of the working machine and lock it with the lock pin. The right draw arm also operates.
- c. Adjust the left and right traction arms to the same height, see the figure

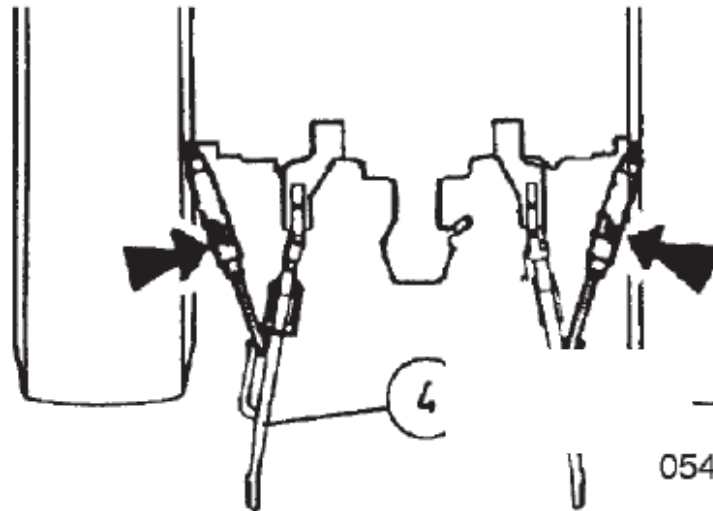

below:

- a. If the tractor's traction arm is too narrow, you can adjust the left suspension pin of the machine inwards, see

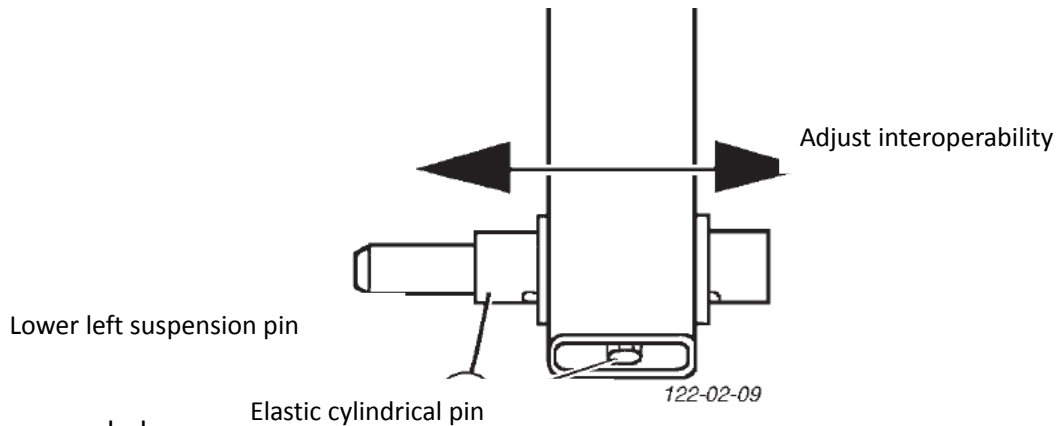

below:

- a. Header angle adjustment. In order to obtain the most suitable cutting angle, the upper link of the three-point tractor must be used to adjust the head cutting angle.

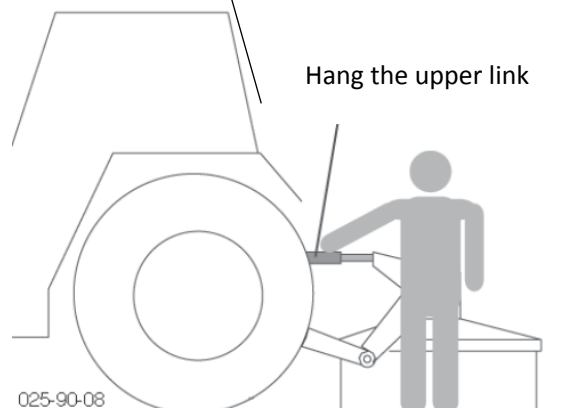

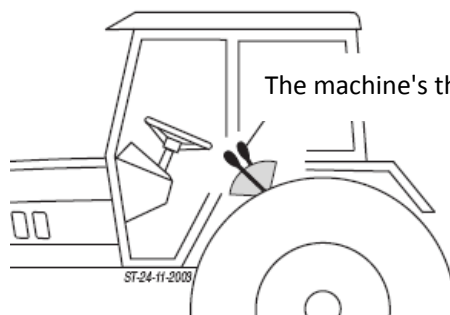

The machine's three-point suspension lifting handle indicates

## 2. Coupling installation



### Danger !

★ If you use a coupling that is not protected by a plastic cover, you may be injured. Do not use couplings without plastic housings.

★ If you use a damaged coupling, you may get injured.

If the coupling is damaged, replace it immediately. Please check the coupling for damage before use.

★ When connecting the tractor and the lawn mower, due to the third party's carelessness, inadvertently rotating the power output shaft, there may be an injury accident. Please disconnect the PTO power and stop the tractor engine before connecting to the tractor.

### (1) Length confirmation

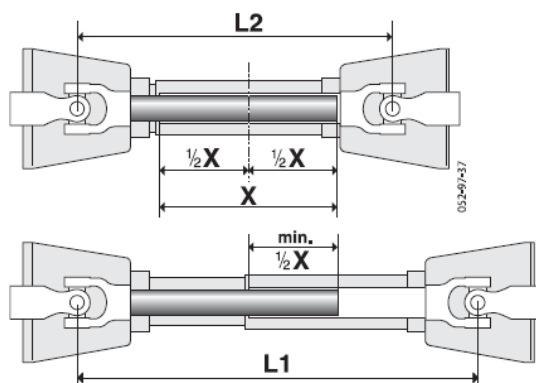

The minimum overlapping  $1 / 2X$  size of the inner and outer tubes of the coupling is 220mm. When the inner and outer tubes overlap less than 100mm, please replace the coupling in time.

L1: The maximum length when connected with the tractor. L2: Minimum length when connected to tractor

X: overlap length.

### (1) Connection of coupling

#### a. Machine connection

Connect one end of the pin base to the input shaft of the machine until the lock pin is exposed in its original position.

b. Fixation of the plastic cover of the

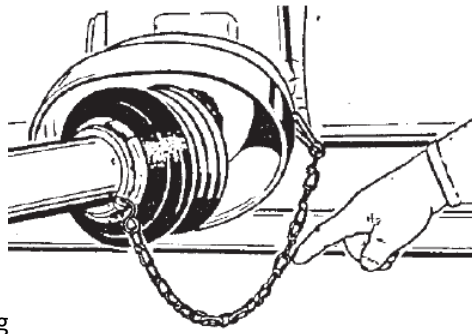

coupling

After the connection is completed, the protective cover chain that comes with the coupling must be fixed to prevent the cover from rotating.

Coupling maximum transmission

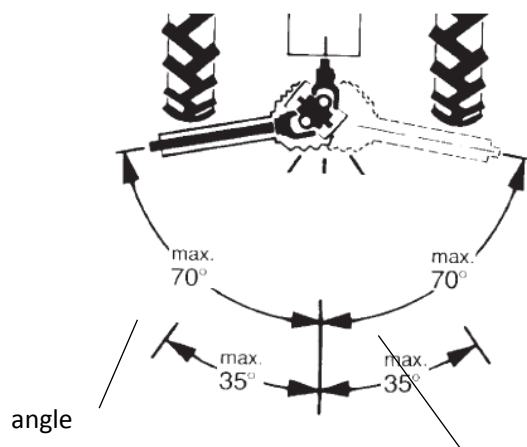

Maximum rotation angle during installation      Maximum rotation angle when working



note! If the transmission shaft exceeds its maximum working rotation angle during operation, unexpected accidents will occur. Be sure to hang and fix the rear three points of the tractor before use.

d. Lubrication and maintenance of the

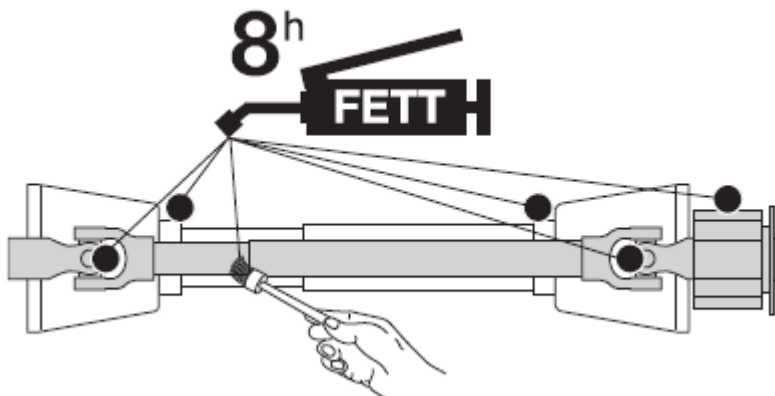

The coupling serves as a power transmission link between the tractor and the

work machine. Proper oil injection lubrication and maintenance will greatly improve the transmission efficiency of the tractor. After the coupling has been running continuously for 8 hours, check the oil injection and lubrication at the point of inspection in the above figure.

## 2. Pre-work inspection

### 1. Inspection before operation

Inspection of various parts of the tractor

Please follow the inspection instructions of the tractor.

#### 1. Inspection of connection parts

(1) Fixation of three-point suspension connecting pin.

(2) Whether the foot support is retracted.

#### 2 Coupling inspection

(1) Whether the two ends of the coupling are effectively fixedly connected to the machine and tractor.

(2) Whether the safety chain is effectively fixed.

(3) Whether the plastic protective cover is complete.

(4) Whether the sag length of the safety chain is appropriate.

#### 3. Rotary tiller inspection

(1) Whether the cutter head blade bolts are tight.

(2) Whether the rotation of the gear box is normal. Whether the hydraulic oil in the gear box exceeds  $\frac{1}{3}$  of the volume. If it is insufficient, the gear oil needs to be added.

(3) Whether the bolts and nuts of each part are tightened.

(4) Whether the fuel is sufficient in all parts.

## 2. Check at engine start



### Danger !

- ★ If you start the engine without cutting off the power of the PTO, it may cause injury to people around you. Be sure to turn off the PTO before starting the engine.
- ★ When starting the engine, if the lawn mower is not brought to a low position, inadvertently falling or rising, it may cause harm to people around. Please turn the lawn mower to a low position before starting the guide.

### 1. Check the drive system

New machines or machines that have not been used for a long time need to run idly.

- (1) Start the tractor engine and transfer it to PTO at low speed.
- (2) Adjust the engine speed to 1000 rpm mode, idle for about 5 minutes.
- (3) If the above situation is normal, adjust the speed to 500-540 rpm mode, idle for about 5 minutes.

If there is a problem with the drive system, refer to the tractor manual for troubleshooting.

### 2. Tractor hydraulic system inspection

Operate the tractor's three-point suspension lifting handle and hydraulic output handle to ensure that the machine is lifted and turned without problems.

If you have any questions, please contact your tractor dealer.

## 3. Gas station summary



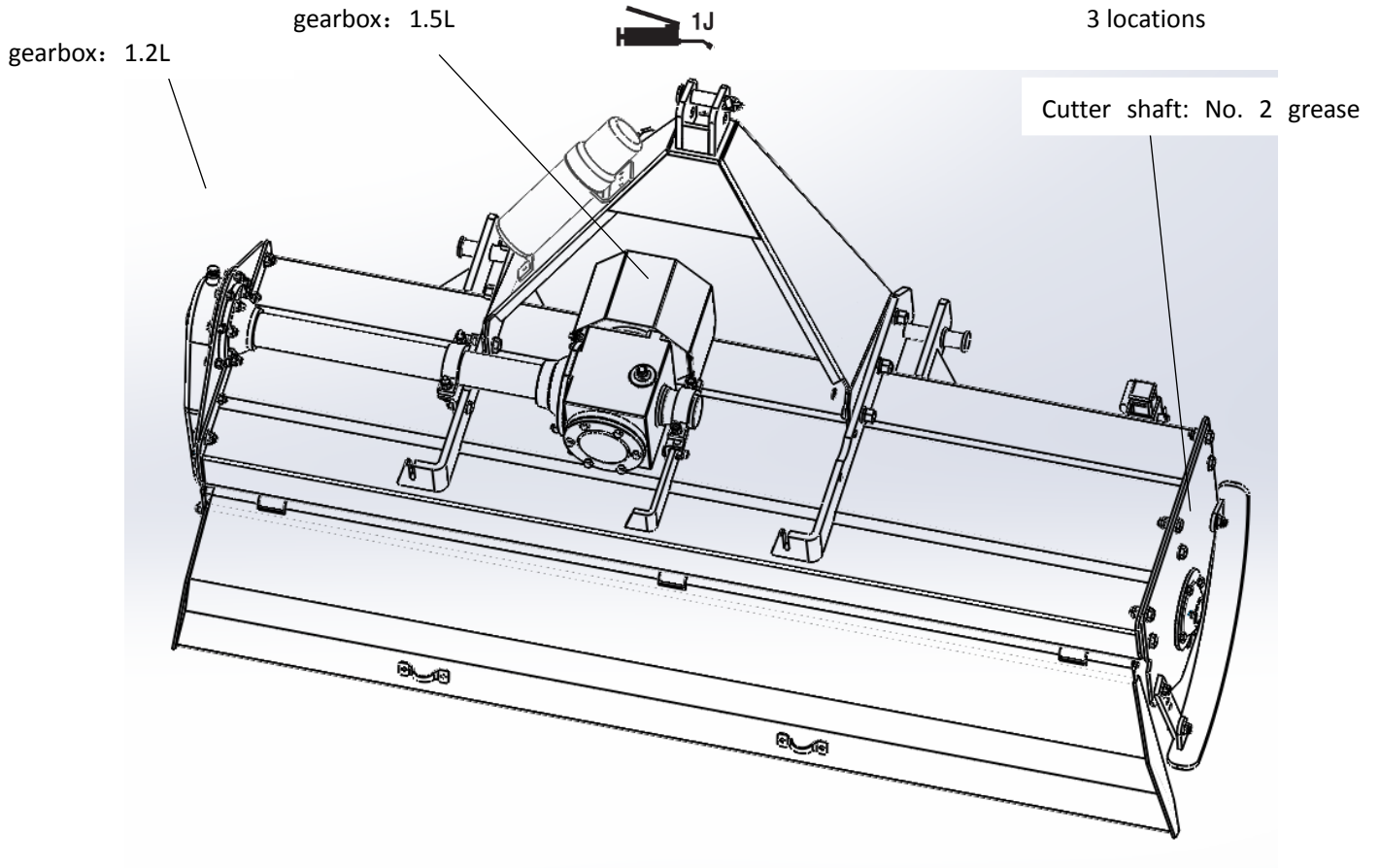

- ★ Refuel with clean oil and apply.
- ★ The oil in the original gear box must be drained out when refueling.
- ★ All parts have been filled with oil at the factory, please confirm before use.

#### 1.GAERBOX

When the new machine is first used, it takes about 50 hours. Please replace with new gear oil.

Perform routine inspections every 50 hours.

Suitable gear oil, grease model

Oil injection	Oil	Oil change time
Gearbox	SAE90 GL-5	300 hours/season change
Grease lubrication	No. 2 grease (butter)	before use

## 4. Operation essentials



### Danger !

- ★ If the cutter head is touched during operation or rotation, an injury accident may occur.
- ★ Because the cutter head rotates at a high speed, the bottom stones will be scattered during the operation. Be careful not to approach people around you during the operation.



### caveat

- ★ If the PTO rotation speed specified by the rotary tiller is exceeded, several damages may occur and cause personal injury. Please perform the cutting operation at the specified rotation speed.
  - ★ Keep working at low speed when working on inclined ground
  - ★ Pay attention to the front and surrounding conditions while driving.

### 一、 Precautions when using

1. At the beginning of the operation, the rotary tiller should be in the lifted state. Combined with the power output shaft, the rotation speed of the blade shaft is increased to the rated speed, and then the rotary tiller is lowered, so that the blade gradually enters the soil to the required depth. It is strictly forbidden to combine the power output shaft or drooping the rotary tiller after the blade is in the soil, so as not to cause the blade to bend or break and increase the load of the tractor.
2. In the operation, the speed should be as low as possible, so that the quality of the operation can be ensured, the soil can be broken finely, and the wear of the machine parts can be reduced. Pay attention to whether there is any noise or metal knocking sound of the rotary tiller, and observe the broken soil and the depth of ploughing. If there is any abnormality, it should be stopped immediately for inspection, and the operation can be continued only after it is eliminated.
3. When turning on the ground, it is forbidden to work, and the rotary tiller should be raised to keep the blade away from the ground, and the tractor throttle should be reduced to avoid damage to the blade. When lifting the rotary tiller, the tilt angle of the universal joint operation

should be less than 30 degrees. If it is too large, it will produce impact noise, which will cause premature wear or damage.

4. When reversing, crossing fields and transferring plots, the rotary tiller should be raised to the highest position and the power should be cut off to avoid damage to the machine parts. If moving to a distant place, use a locking device to fix the rotary tiller.

5. After a shift, the rotary tiller should be maintained. Remove the dirt and weeds from the blade, check the tightening of each connecting piece, add lubricating oil to each lubricating point, and add grease to the universal joint to prevent increased wear.

## 二、 Rotary tiller adjustment

1. Left and right horizontal adjustment. Stop the drag with the rotary tiller on the flat ground for the first time, lower the rotary tiller so that the blade is 5 cm away from the ground, and observe whether the height of the left and right blade tips is the same to ensure that the blade axis is level and the ploughing depth is uniform during the operation.

2. Horizontal adjustment before and after. When lowering the rotary tiller to the required depth, observe whether the angle between the universal joint and the axis of the rotary tiller is close to the horizontal position. If the angle of the universal joint is too large, the upper lever can be adjusted so that the rotary tiller is in a horizontal position.

3. Lifting height adjustment. In the rotary tilling operation, the angle of the universal joint is not allowed to be greater than 10 degrees, and it is not allowed to be greater than 30 degrees when turning the ground. Therefore, the lifting of the rotary tiller should be limited to the appropriate position of the handle for the available screws used for position adjustment; when using height adjustment, special attention should be paid when lifting. .

## 5. End of homework

1. Finishing and inspection after the work

(1) After the operation is completed, the rotary tiller needs to be sorted and cleaned to remove the grass residue and soil remaining on the header due to the operation.

(2) After use, pay attention to check that some parts of the rotary tiller can be damaged. If you need to replace some parts, you must also cut off all power and stop the tractor. Only then can the parts be replaced.

(3) For the parts that are most likely to be damaged during use, a careful inspection of the damaged parts should be immediately awakened and replaced so as not to affect the next use. The blade of the cultivator is the most susceptible to damage. There are generally three methods for replacement: outward rotation, inward rotation, and mixed installation. The three methods are respectively adapted to different working environments. Pay attention to the distinction; pay attention when adjusting the blade of the cultivator The speed of the cutter shaft.

## 2. Separation from tractor

(1) Pull both ends of the PTO drive shaft from the tractor end and the input end of the rotary tiller.

(2) Level the rotary tiller and separate the tractor three-point suspension from the rotary tiller three-point suspension pin.

## 3. save

When the machine is not used for a long time, please be sure to do the inspection work first, fill in the oil in time, and do the dustproof work.

# 6. Spot inspection and component

## 1. Checklist

Check content	time
blade	Before/after/homework
Cutter	Before/after homework
Oil lubrication	50 hours/time
Loose bolts and nuts	1 hour for new products
Gear Oil	50 hours for new machines, every 300 hours after oil change or season change

## 7. Handling of abnormal situations

Serial number	abnormal situation	the reason	Treatment
1	Abnormal sound or abnormal	<ol style="list-style-type: none"> <li>1. Loosening of cutter head bolts</li> <li>2. Loose nut of fixed cutter head</li> <li>3. Unfavorable oil quantity</li> <li>4. Damage of gears and bearings</li> <li>5. Excessive load, too hard soil</li> </ol>	Tighten  Oil change Replacement parts Readjust the depth of cultivation
2	Uneven soil after sowing of cultivated land	<ol style="list-style-type: none"> <li>1. The position of the pallet is not adjusted properly</li> </ol>	Adjust the position of the pallet
3	The knife shaft does not turn or rotates slowly	<ol style="list-style-type: none"> <li>1. Parts installation error</li> <li>2. Too much weed inside the shaft</li> </ol>	Check cutter shaft installation Remove weeds
4	Blade bending	<ol style="list-style-type: none"> <li>1. The deformed blade is not replaced</li> </ol>	Replace the blade
6	Coupling abnormal sound	<ol style="list-style-type: none"> <li>1. without oil</li> <li>2. The load angle is too large</li> </ol>	Add lubrication Use as specified

## 8. Product Parts Atlas



POS.	COD.	Specification	Description	180	150	090	135	125	105	100
1	2020001 246	LG180A.011	Panel hood	1	-	-	-	-	-	-
1	2020001 245	LG150A.011	Panel hood	-	1	-	-	-	-	-
1	2020001 240	LG90A.011	Panel hood	-	-	1	-	-	-	-
1	2020001 244	LG135A.011	Panel hood	-	-	-	1	-	-	-
1	2020001 243	LG125A.011	Panel hood	-	-	-	-	1	-	-
1	2020001 242	LG105A.011	Panel hood	-	-	-	-	-	1	-
1	2020001 241	LG100A.011	Panel hood	-	-	-	-	-	-	1
2	2020001 232	LG180A.012.JL	Side plate-R	1	1	1	1	1	1	1
3	2020001 233	LG180A.013	Side plate-L	1	1	1	1	1	1	1
4	2020001 264	LG180.015	Baffle plate	1	-	-	-	-	-	-
4	2020001 263	LG150.015	Baffle plate	-	1	-	-	-	-	-
4	2020001 258	LG90.015	Baffle plate	-	-	1	-	-	-	-
4	2020001 262	LG135.015	Baffle plate	-	-	-	1	-	-	-
4	2020001 261	LG125.015	Baffle plate	-	-	-	-	1	-	-
4	2020001 260	LG105.015	Baffle plate	-	-	-	-	-	1	-
4	2020001 259	LG100.015	Baffle plate	-	-	-	-	-	-	1
5	201 0000469	LG180.102	Baffle plate shaft	1	-	-	-	-	-	-
5	201 0000468	LG150.102	Baffle plate shaft	-	1	-	-	-	-	-
5	201 0000463	LG90.102	Baffle plate shaft	-	-	1	-	-	-	-
5	201 0000467	LG135.102	Baffle plate shaft	-	-	-	1	-	-	-
5	201 0000466	LG125.102	Baffle plate shaft	-	-	-	-	1	-	-
5	201 0000465	LG105.102	Baffle plate shaft	-	-	-	-	-	1	-
5	201 0000464	LG100.102	Baffle plate shaft	-	-	-	-	-	-	1
6	2020001 236	LG180.019	Skating plate-L	1	1	1	1	1	1	1
7	2000000609	LG180.108	Adjustable plate	2	2	2	2	2	2	2
8	2020001 237	LG180.024	Skating plate-R	1	1	1	1	1	1	1



POS.	COD.	Specification	Description	180	150	090	135	125	105	100
9	2020001 270	LG180.016	Hitch bracket	1	-	-	-	-	-	-
9	2020001 269	LG150.016	Hitch bracket	-	1	1	1	1	1	1
10	3160100017	XH50A.011	Gear box	1	-	-	-	-	-	-
10	3160100018	XH50A.010	Gear box	-	1	-	-	-	-	-
10	3160100021	XH50A.006	Gear box	-	-	1	-	-	-	-
10	3160100019	XH50A.008	Gear box	-	-	-	1	1	-	-
10	3160100020	XH50A.007	Gear box	-	-	-	-	-	1	1
11	3170500038	S.ZL130.118	Paper washer	1	1	1	1	1	1	1
12	2000000606	LG180.101	Buckle plate	2	2	2	2	2	2	2
13	2000000608	LG180.107	Sustaining plate	2	2	2	2	2	2	2
14	2000000611	LG180.141	Guard plate	1	1	1	1	1	1	1
15	11000202196	LG180.027	Shielding cover seat plate	1	1	1	1	1	1	1
16	2000000607	LG180.106	Holding plate for P TO	1	1	1	1	1	1	1
17	3160600036	LG180.112.jl	Gear	1	1	1	1	1	1	1
18	3080800011	GB 858-1988	Tab washer 30x1	2	2	2	2	2	2	2
19	3050900011	GB/T 812-1988	Round nut M30x1.5	2	2	2	2	2	2	2
20	3150200030	LG180.115	Gear shaft	1	1	1	1	1	1	1
21	3160600006	LG180A.111	Middle gear	1	1	1	1	1	1	1
22	3170200008	GB 3452.1-92	O-ring 145x3.55	1	1	1	1	1	1	1
23	2090000538	6208	Bearing configuration	1	1	1	1	1	1	1
24	3080600046	GB 893.1-86	Circlip for hole-type A 80	1	1	1	1	1	1	1
25	3080700026	GB 894.1-86	Circlip for shaft-type A 40	1	1	1	1	1	1	1
26	3170100045	GB/T 13871.1-2007	TC Oil seal 55x80x12	1	1	1	1	1	1	1
27	2090000540		Bearing configuration	1	1	1	1	1	1	1
28	3080600054	GB 893.1-86	Circlip for hole-type A 100	1	1	1	1	1	1	1
29	3150200029	LG180.114	Shaft	1	1	1	1	1	1	1

POS.	COD.	Specification	Description	180	150	090	135	125	105	100
30	3160600023	LG180-113	Driven gear	1	1	1	1	1	1	1
31	2090000539	6306	Bearing configuration	1	1	1	1	1	1	1
32	3170100009	GB/T 13871.1-2007	TC Oil seal 35x62x1.2	1	1	1	1	1	1	1
33	2090000537	LG180-00-01	Blade axle assembly	1	-	-	-	-	-	-
33	2090000536	LG150-00-01	Blade axle assembly	-	1	-	-	-	-	-
33	2090000531	LG90-00-01	Blade axle assembly	-	-	1	-	-	-	-
33	2090000535	LG135-00-01	Blade axle assembly	-	-	-	1	-	-	-
33	2090000534	LG125-00-01	Blade axle assembly	-	-	-	-	1	-	-
33	2090000533	LG105-00-01	Blade axle assembly	-	-	-	-	-	1	-
33	2090000532	LG100-00-01	Blade axle assembly	-	-	-	-	-	-	1
34	3040100065	GB/T 5783-2000	Hexagon head bolt-Full thread M12x25	1	1	1	1	1	1	1
35	3080200010	GB/T 96.2-2002	Large plain washer 12x3	1	1	1	1	1	1	1
36	3170400003	JB/T 7940.1-1995	Grease nipple M8x1	1	1	1	1	1	1	1
37	3220400007	LG180-109	Bearing cover-R	1	1	1	1	1	1	1
38	3170500037	LG180.121	Paper pad	1	1	1	1	1	1	1
39	3080500008	GB/T 93-1987	Spring washer 10	4	4	4	4	4	4	4
40	3040100043	GB/T 5783-2000	Hexagon head bolt-Full thread M10x25	6	6	6	6	6	6	6
41	3170500039	LG180.122	Cork gasket	1	1	1	1	1	1	1
42	2020001235	LG180.018	Gearbox cover	1	1	1	1	1	1	1
43	3170400013	M16*1.5 (JYG-82)	Breather plug	1	1	1	1	1	1	1
44	3040500006	JBZQ 4770-2006	Outer hexagonal plug M16x1.5	1	1	1	1	1	1	1
45	3170300012	M16	Combined sealing gaskets M16	2	2	2	2	2	2	2
46	3170300009	M10	Combined sealing gaskets M10	1	1	1	1	1	1	1
47	3040100063	GB/T 5783-2000	Hexagon head bolt-Full thread M12x16	1	1	1	1	1	1	1
48	2000000610	LG180.110	Guard plate	1	1	1	1	1	1	1
49	3040100046	GB/T 5783-2000	Hexagon head bolt-Full thread M10x35	13	13	13	13	13	13	13



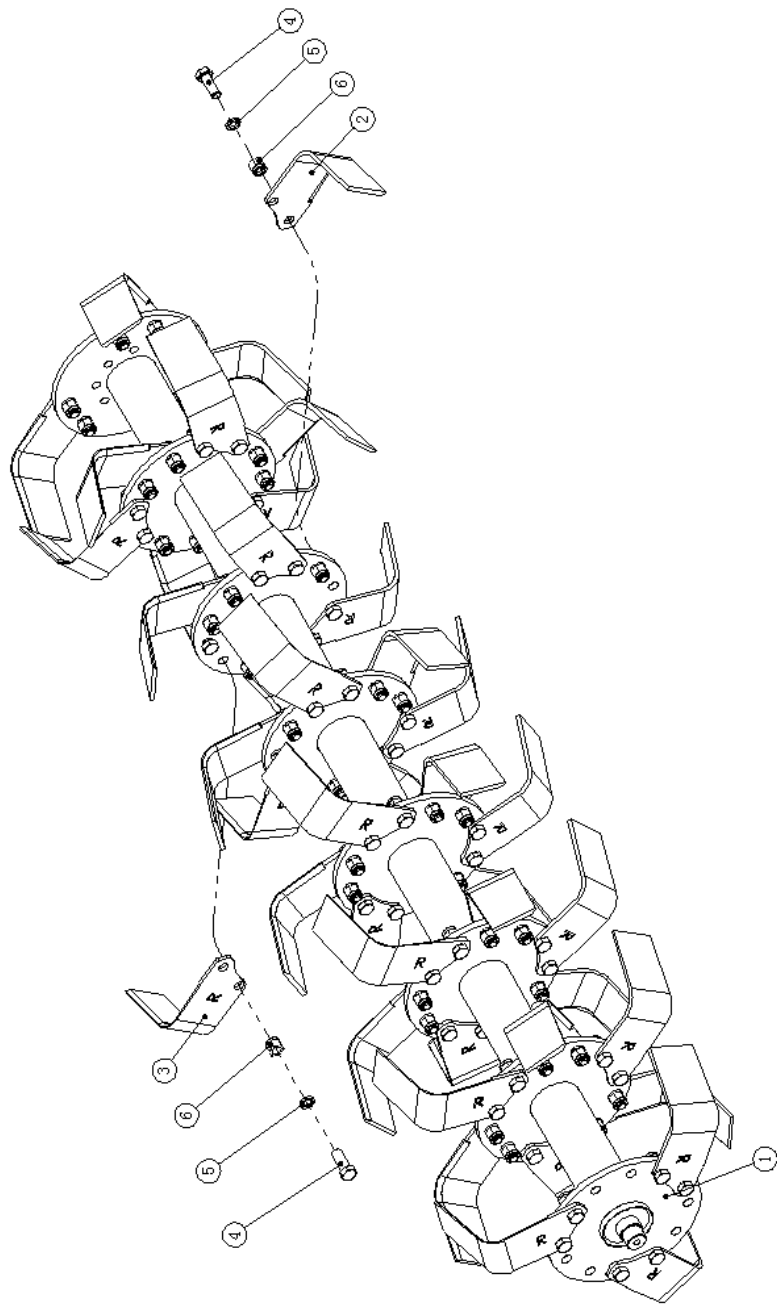

POS.	COD.	Specification	Description	180	150	090	135	125	105	100
50	3080100006	GB/T 95-2002	Plain washer 10×2	56	56	56	56	56	56	56
51	3050500004	GB/T 889.1-2000	Locknut M10	28	28	28	28	28	28	28
52	3040100045	GB/T 5783-2000	Hexagon head bolt-Full thread M10×30	13	13	13	13	13	13	13
53	3080500010	GB/T 93-1987	Spring washer 14	10	10	10	10	10	10	10
54	3080100008	GB/T 95-2002	Plain washer 14×2.5	16	16	16	16	16	16	16
55	3040100091	GB/T 5783-2000	Hexagon head bolt-Full thread M14×35 CL8.8	10	10	10	10	10	10	10
56	3050500008	GB/T 889.1-2000	Locknut M14	6	6	6	6	6	6	6
57	3040100067	GB/T 5783-2000	Hexagon head bolt-Full thread M12×30	13	13	13	13	13	13	13
58	3080500009	GB/T 93-1987	Spring washer 12	15	15	15	15	15	15	15
59	3080100007	GB/T 95-2002	Plain washer 12×2.5	43	43	43	43	43	43	43
60	3050500009	GB/T 889.1-2000	Locknut M16	6	6	6	6	6	6	6
61	3080500011	GB/T 93-1987	Spring washer 16	6	6	6	6	6	6	6
62	3080100009	GB/T 95-2002	Plain washer 16×3	12	12	12	12	12	12	12
63	3040100108	GB/T 5783-2000	Hexagon head bolt-Full thread M16×50	6	6	6	6	6	6	6
64	3040100022	GB/T 5783-2000	Hexagon head bolt-Full thread M8×20	7	7	7	7	7	7	7
65	3080500007	GB/T 93-1987	Spring washer 8	7	7	7	7	7	7	7
66	3080100004	GB/T 95-2002	Plain washer 8×1.6	7	7	7	7	7	7	7
67	3050500007	GB/T 889.1-2000	Locknut M12	14	14	14	14	14	14	14
68	3040100072	GB/T 5783-2000	Hexagon head bolt-Full thread M12×45	4	4	4	4	4	4	4
69	3040100071	GB/T 5783-2000	Hexagon head bolt-Full thread M12×40	8	8	8	8	8	8	8
70	3040100069	GB/T 5783-2000	Hexagon head bolt-Full thread M12×35	2	2	2	2	2	2	2
71	3120500022	LG180-105	Hitch pin-Lower	2	-	-	-	-	-	-
72	2010000369	LG180.105B	Sleeve	2	-	-	-	-	-	-
73	3120400007	11*45	Safety pin 11*45	3	3	3	3	3	3	3
74	2010000470	LG180.104	Hitch pin-upper	1	1	1	1	1	1	1
75	2020001234	LG180.017	Raker	1	1	1	1	1	1	1

POS.	COD.	Specification	Description	180	150	090	135	125	105	100
76	2010000017	EF175-116	Raker pin	1	1	1	1	1	1	1
77	3120400008	3.5	R pin 3.5	1	1	1	1	1	1	1
78	3210200004	BCR140-114	Square pipe plug 41x41	1	1	1	1	1	1	1
79	3130600005	8	Type D shackle	2	1	1	1	1	1	1
80	3130100016	LG180-130	Galvanized chain(0.616M)	2	1	1	1	1	1	1
81	3160200050	T5S-BS-07-07-800	Drive shaft	1	1	1	1	1	1	1
82	3120100075	GB/T 91-2000	Split pin 3.2*25	2	2	2	2	2	2	2
83	2010000471	LG150.105	Hitch pin-lower	-	2	2	2	2	2	2
84	3080500015	GB/T 93-1987	Spring washer 24	-	2	2	2	2	2	2
85	3050100014	GB/T 41-2000	Nut M24	-	2	2	2	2	2	2
86	3080100013	GB/T 95-2002	Plain washer 24x4	-	2	2	2	2	2	2

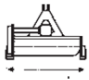
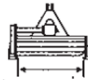

POS.	COD.	Specification	Description	180	150	135	125	105	100	090
1	2020001257	LG 180.014	Blade axle	1	-	-	-	-	-	-
1	2020001256	LG 150.014	Blade axle	-	1	-	-	-	-	-
1	2020001255	LG 135.014	Blade axle	-	-	1	-	-	-	-
1	2020001254	LG 125.014	Blade axle	-	-	-	1	-	-	-
1	2020001253	LG 105.014	Blade axle	-	-	-	-	1	-	-
1	2020001252	LG 100.014	Blade axle	-	-	-	-	-	1	-
1	2020001251	LG 90.014	Blade axle	-	-	-	-	-	-	1
2	3220100037	LG 180.116	Blade-L	21	18	15	15	12	12	9
3	3220100038	LG 180.117	Blade-R	21	18	15	15	12	12	9
4	3040200024	G B/T 5786-2000	Hexagonal head bolt-Full thread M 14×1.5×40	84	72	60	60	48	48	36
5	3080500010	G B/T 93-1987	Spring washer 14	84	72	60	60	48	48	36
6	3050600006	G B/T 889.2-2000	Locknut M14x1.5	84	72	60	60	48	48	36

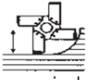
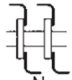
## 9. Main technical parameters of rotary tiller

MODELLO												
	cm.	inc.	cm.	inc.		cm.	HP	KW	cm.		inch.	N.
LG90	111	43.7	90	35.4	55-55	15/25	11/18	18	7	4	250	551.0
LG100	121	47.6	100	39.4	60-60	15/25	11/18	18	7	5	258	568.6
LG105	127	50.0	105	41.3	63-63	20/30	15/22	18	7	5	262	577.4
LG125	148	58.3	125	49.2	74-74	25/35	18/25	18	7	6	285	628.1
LG135	157	61.8	135	53.1	78-78	30/45	22/33	18	7	6	300	661.2
LG150	172	67.7	150	59.1	86-86	35/50	25/36	18	7	7	320	705.3
LG180	202	79.5	180	70.9	101-101	35/55	25/40	18	7	8	355	782.4

## 10. Consumable parts list

Serial number	Code	Material code	name	Quantity	Location
1	LG180.116	3220100037	Left blade	9/12/12/15/15/18/21	Cutter
2	LG180.117	3220100038	Right blade	9/12/12/15/15/18/21	Cutter
3		3100100048	Deep groove ball bearings 6306	1	Knife shaft
4		3100100056	Deep groove ball bearings 6309	1	Knife shaft
	TC55*80*12	3170100045	Oil seal	1	Knife shaft
	TC35*62*12	3170100009	Oil seal	1	Knife shaft

